

TESTING TERMINAL BOARD

ZS4, ZS4-M



ZS4 (order nr. V1 31069.001)



ZS4-M (order nr. V1 31069.002)

The testing terminal board ZS4 / ZS4-M (three-wire conduit) is designed for electrical devices where is a need for changing or checking of a working measuring instrument (during switching off of an electricity meter connected to secondary circuits while measuring of current and voltage transformers) and where is necessary to keep the terms of uninterrupted secondary circuits of measuring current transformers.

The testing terminal board ZS4 / ZS4-M has a special design – every triplet of current terminals can be reciprocally connected by screws fastening. The terminal board could be mounted by two ways: to lock it on a DIN 35 mm bar or fasten it by four M4 screws.

The voltage supplies are connected through a voltage terminal or through fuse block (not included in delivery). There is a sufficient space for these terminals under the terminal cover (type ZS4 only).

To tighten the screws ZS4 / ZS4-M is a bit PH1 needed. For M3 screws is tightening torque of 0.5 Nm (EN 60999). Terminal screws complies as per EN ISO 6507-1.

TECHNICAL DATA

Max. rated voltage	230 / 400V, 50-60 Hz
Max. rated current	16 A
Size of terminal board	79x71x35 mm
Size of cover ZS4	154x118x50,5 mm
Size of cover ZS4-M	83x53x3 mm
Terminal diameter	4 mm
Max. conductor cross-section cable	6 mm ²
Max. conductor cross-section strand	6 mm ²
Fixing screw of terminals	2 x M3 x 10 mm

DIMENSIONAL SKETCH

Section B-B

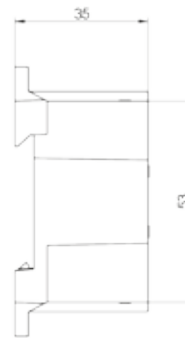
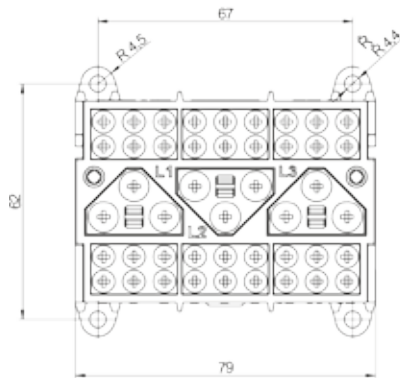
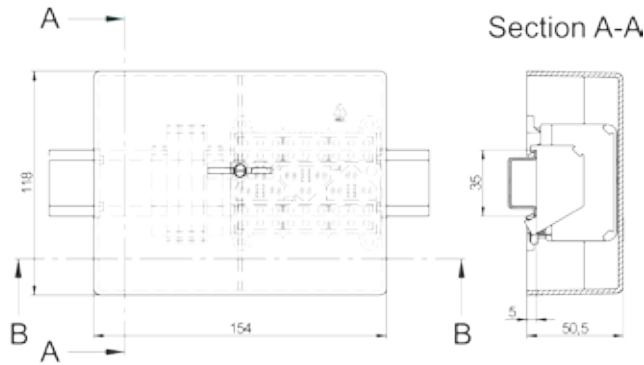
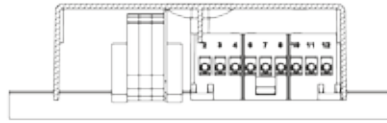

WIRING DIAGRAM EXAMPLE

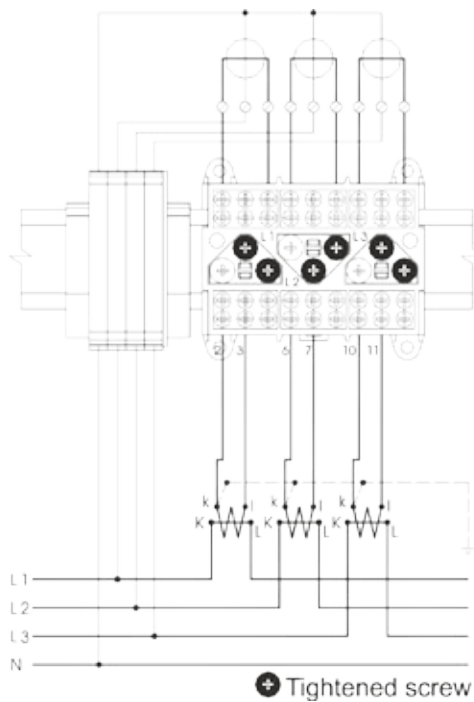

Connection of terminal board ZS4 / ZS4-M with connected electricity meter

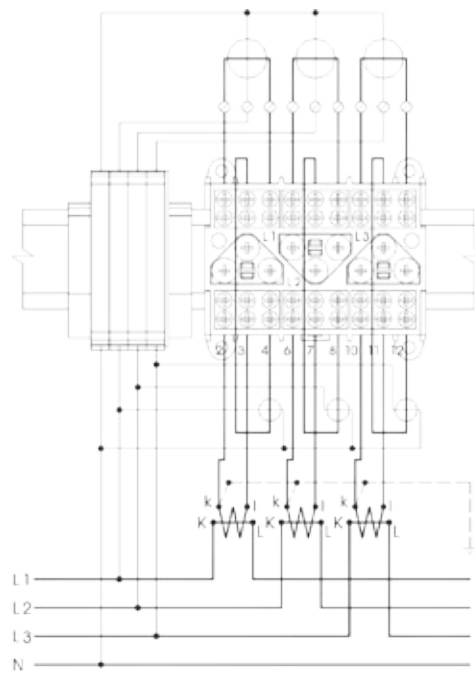

Connection of terminal board ZS4 / ZS4-M with connected electricity meter and control measuring devices

MAINTENANCE AND STORAGE

Care And Maintenance

The device is a maintenance-free product with determined minimum operation service life of 15 years. For possible cleaning of the outside surface from dust and other impurities, the manufacturer does not recommend using organic solvents, aggressive chemicals and abrasive cleaning agents. Prescribed storage temperatures shall be complied with: failure to do so can result in shortening of electronic components service life. The product shall be protected against wet and humid conditions. It is designed for internal use, i.e. it may be used only in places providing additional protection against the effects of external environment (e.g. in a building or cabinet). Precipitation, humidity and liquids containing minerals can cause corrosion of electric circuits if the device becomes wet. The product shall not be placed on and dried by a source of heat or inserted into a source of heat (e.g. microwave oven, classic oven or radiator / heater) as it can overheat and some of its parts explode. It shall not be exposed to excessive heat as it can lead to deformation of case / cover. The device shall not be stored in cold premises, especially with subsequent warming-up (to nominal operation temperature). Humidity can condensate inside and damage electronic components or isolation properties of the product can deteriorate.

Service

Service shall be ensured by: ZPA Smart Energy a.s., Komenského 821, 541 01 Trutnov, Czech Republic, Trademark Smart Energy, Tel. + 420 499 907 111, E-mail: zpa@zpa.cz, www.zpa.cz.

Transport

The device shall be packed for transport either in the original package, in which it was delivered by the manufacturer, or in a package causing / ensuring no damage due to handling or transport.

SAFETY

Manufacturer Warnings

The product is capable of safe operation. The manufacturer has issued the EU Declaration of Conformity as per Act 90/2016 Coll. Despite this fact, the manufacturer warns of the risk of possible danger resulting from incorrect handling or incorrect use of the product as follows:

- Installation and maintenance must be performed by a personnel with the corresponding electro-technical qualification and adequately trained, that shall inform the operator on conditions of safe operation;
- The product shall not be used for purposes other than those it was manufactured for;
- The product shall not be willfully modified contrary to the type design;
- The product shall not be operated with voltage, current or frequency other than those it was produced or professionally modified for;
- The product shall be located and secured so as to complicate or disable handling by persons with no electro-technical qualification, especially children;
- Before every new putting to operation, e.g. after repair, maintenance etc., Ingress Protection shall be restored in full, all safety measures taken and inspection done by a designated electrical inspector;
- During operation, premises where the device is installed, shall be free of danger of fire or explosion in case of development of gases, vapors of inflammable liquids and occurrence of inflammable dust,
- The product shall be handled by a qualified and adequately trained person only, and handling shall be performed without voltage with the exception of measurement by measuring meter with insulated tips;
- The product shall not be operated under conditions or in an environment not ensuring safe operation (e.g. location on flammable base, cover from inflammable material, insufficient protection from penetration of foreign elements, water or other liquids);
- The product shall be located and operated in an indoor environment, i.e. in places providing additional protection against effects of external environment (e.g. inside a building or cabinet).
- The product shall not be operated in an environment with major vibrations and oscillations or under such conditions.

Failure of the user to observe any of the aforesaid warnings renders the manufacturer not being liable for a defect occurring as an incidental consequence of this failure. Non-observance of storage and operation conditions recommended in article Care And Maintenance can have an adverse effect on the product service life.

Responsibility

The owner of the device is responsible for ensuring that all persons engaged in working and handling the product:

- Are knowledgeable and qualified as per national regulations;
- Have read and understood corresponding parts of this document;
- Strictly observe safety regulations and operation data stipulated in its individual articles.

The owner of the device is further responsible for:

- Protection of persons;
- Prevention of damage to material;
- Personnel training.

Safety Instructions

The following safety instructions shall be observed under all circumstances:

- Wires the device is connected to shall be powered neither during installation nor replacement. Powered contacts pose a life threat. For this reason, until the work is finished, the corresponding power supply fuses shall be removed and stored in a place, safeguarding against unnoticed reinstallation by a person holding no responsibility;
- Local safety regulations shall be observed. The device installation shall be executed solely by qualified and trained personnel;
- With no exception, prior to terminal cover opening, current transformer secondary circuits shall be short circuited. High voltage generated during current transformer circuit interruption poses a life threat and damages the transformer;
- The product shall by no means be cleaned under running water or by high-pressure equipment. Water penetration can cause a short circuit. It is necessary to respect ingress protection of the device.

DISPOSAL

As per certificate ISO 14001 data, the components used in the device are mostly separable and so can be disposed of or recycled accordingly. At the end of its service life, the device shall be handed over to specialized companies dealing in used material separation and consequent recycling. An unused device shall be disposed of ecologically as per the Waste Act.

The device contains no radioactive, carcinogenic or other materials having an adverse effect either on human health or the environment. All plastic materials can be recycled.

Packing is recyclable and at the end of its service life shall be handed over to specialized companies as a source of secondary raw materials or energy.

Liquidation and Legal Regulations Concerning the Environment Protection

The product disposal shall strictly observe local regulations for environment protection.

Components	Disposal
Metal parts	Separate and hand over to the waste collection center for disposal as per local regulations.
Plastic components	Separate and hand over for disposal or re-granulation as per local regulations.